

TILE COLLECTION INSTALLATION

| Panel | Dimensions (HxWxD) | Type |
|-------|-----------------------|--------------------|
| A | 2440mm x 1220mm x 4mm | Square Edged Panel |
| B | 1220mm x 2440mm x 4mm | Square Edged Panel |

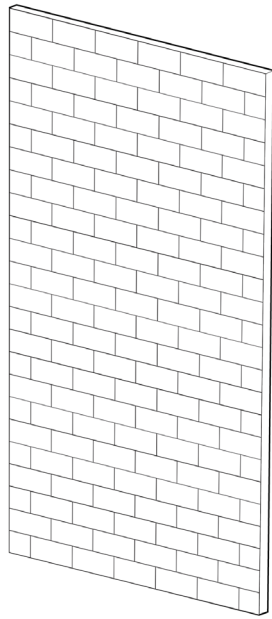

A

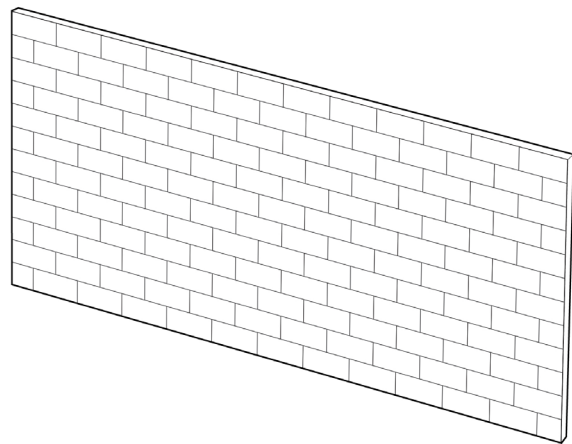

B

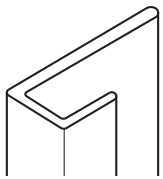

End Cap

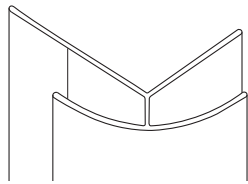

External Corner

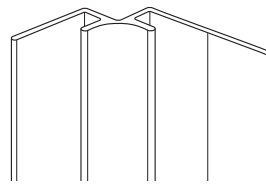

Internal Corner

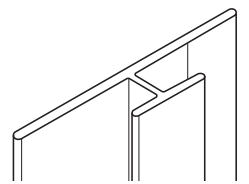

H-Joint

STORAGE



**HANDLE
WITH CARE**

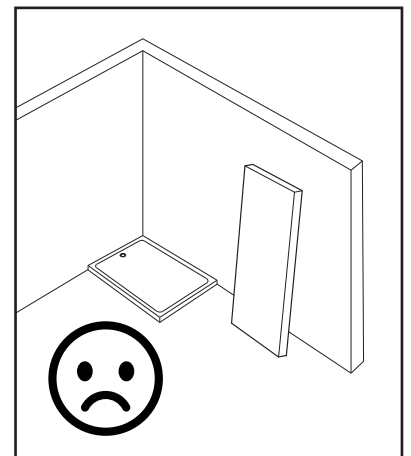
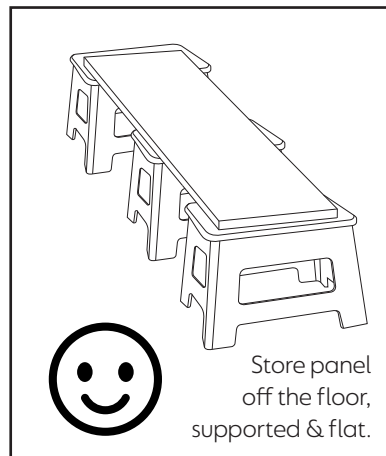
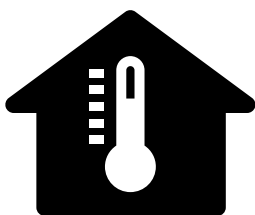

TOOLS

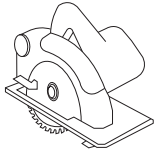

Circular Saw

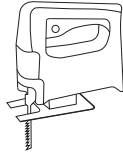

Jig Saw

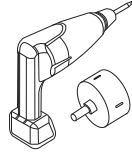

Drill

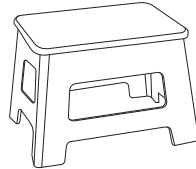

Stool/Tressle

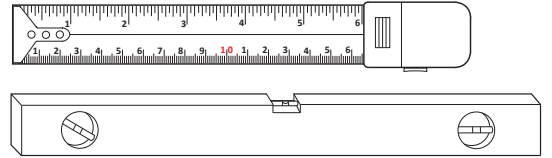

Measuring Tape & Spirit Level

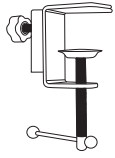

Clamp

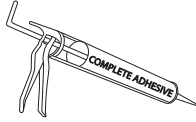

Adhesive



Sealant

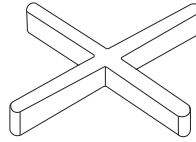

Spacers

SAFETY EQUIPMENT

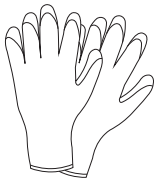

Gloves



Goggles



Boots



Dust Mask

Damages/Defects

Always check for compatibility of colour and surface prior to installation as slight variations can occasionally occur. If a problem is identified, please contact your supplier immediately, who will be happy to deal with any issues. Once a panel is fitted or cut, it is deemed acceptance of product. Check the panels thoroughly for signs of damages or defects and NEVER begin installation until you are 100% happy. Claims for defects/damages can not be made after installation begins.

Installation Tips

- **We highly recommend performing a 'dry fit' of the install, for alignment purposes.**
- Use ONLY Wilsonart Complete adhesives and sealants to validate the Lifetime Guarantee.
- **Wilsonart carry a Lifetime Guarantee; being whilst the original purchaser/homeowner owns the product and this is not transferable. Wilsonart will make good by repair and/or replacement (at its discretion) any Wilsonart product of its manufacture which can be shown to have failed by reason of defects in its manufacture, subject to fair wear and tear, provided the product has been installed and used in accordance with the manufacturer's instructions and that the products are used for their intended purpose/application. Proof of date and place of purchase is required. Installation to our guidelines and use of our sealants and adhesives are a condition of this guarantee.**
- **This guarantee is in addition to your statutory rights as a consumer and does not affect your rights in any way.**
- Position all joints vertically especially in wet areas.
- Always start panel installations from a corner, working out.
- In a shower area if the profiles are not being used then a 3mm expansion gap should be left between the edge of the panel and any adjoining surface, this gap should then be sealed with sealant.
- A 3mm - 4mm gap must be left between the bottom of the panel and top of the shower tray or bath, this can be achieved by using packers when fixing panels. The gaps should then be sealed ensuring that the silicone is forced into the void.
- Use white spirit and a clean wipe to remove excess adhesive.

WALL PREPARATION

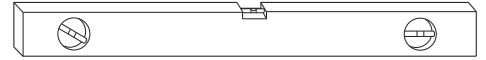

Ensure walls are level, dry, clean & damp free. Fixtures and Fittings **MUST** be secured to the wall behind the panel and pipework fed through. Composite panels must be fitted to a continuous surface such as plaster board, existing tiling, chipboard & plywood sheathing and tile backers providing the surface it is sound, plumb and level. Some surfaces do require pre-treatment before installation, tiles should be de-greased and fresh plaster should be sealed with a proprietary PVA sealer.

It is important to ensure that there are no areas of wall to be clad where there are distinct differences in shading such as tape lines in plaster boarding and grout lines in tiling as these can show through when installing lighter colours.

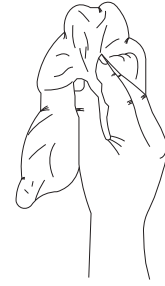

CUTTING THE PANELS

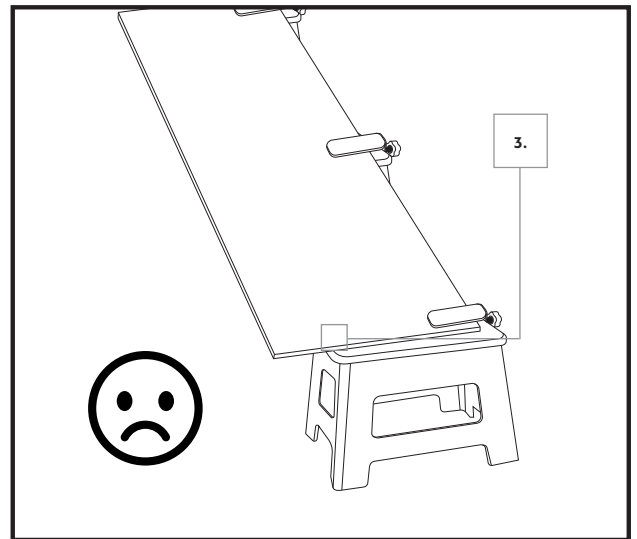
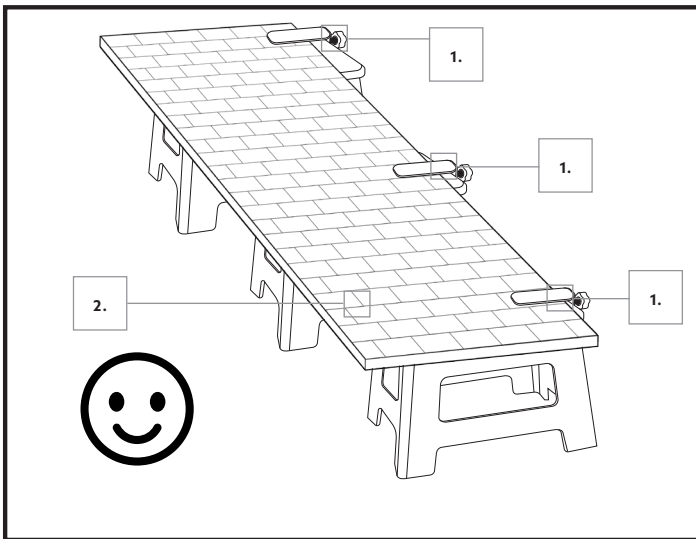

1. Fully Secure the panel

2. When cutting the panels using a jigsaw with an 'up-cut' blade or with a circular saw then the decorative side of the panel should be facing down. If cutting using a hand saw then the decorative side should be facing up. 3. NEVER have the panel overhang the edge

3. Cut edges *must* be sanded

Circular Saw

Tungsten Carbide Tipped (TCT) blades that are designed for metals or plastics should be used as these will be fine toothed and give the best finish, the following recommendations should be followed:

Jigsaw

Jigsaw blades that are specifically designed to cut Acrylic should be used. There are a lot more specialist jigsaw blades available, such as: <https://www.bosch-professional.com/gb/en/t-102-bf-clean-for-pmma-jigsaw-blades-2867886-ocs-ac/> A high speed should be selected and the rotary action switched off.

Router

A straight TCT fluted cutter should be used with a cutting speed of 4500m/min .

DRILLING THE PANELS

Drill bits specifically designed for Acrylic should be used and TCT hole saws should be used at low speed and pressure. In both cases the Composite must be supported from underneath.

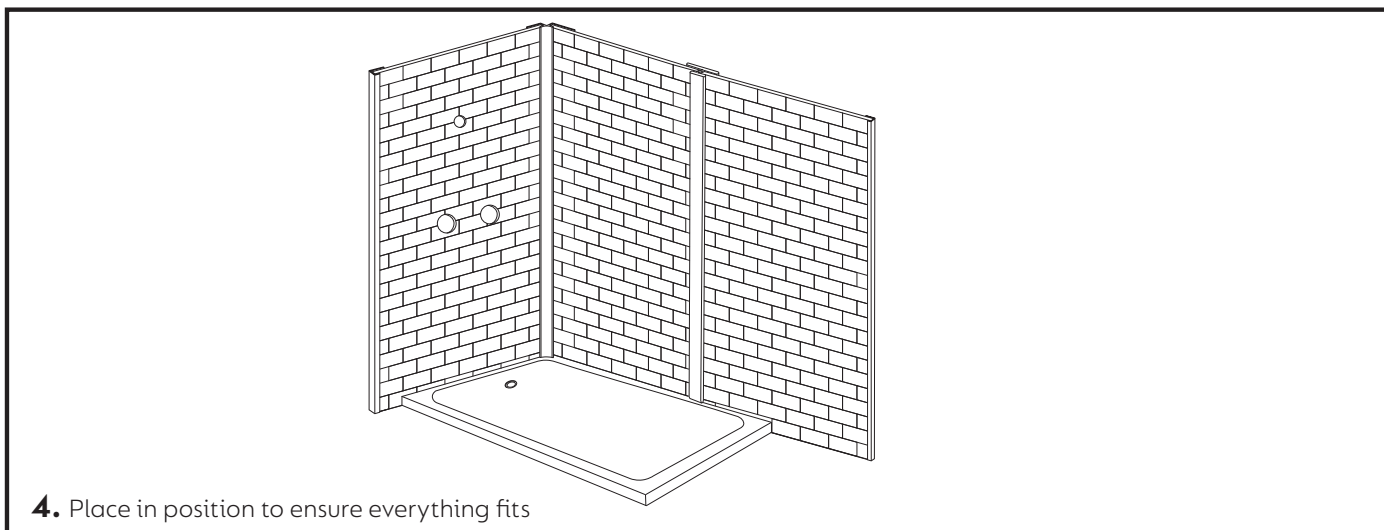
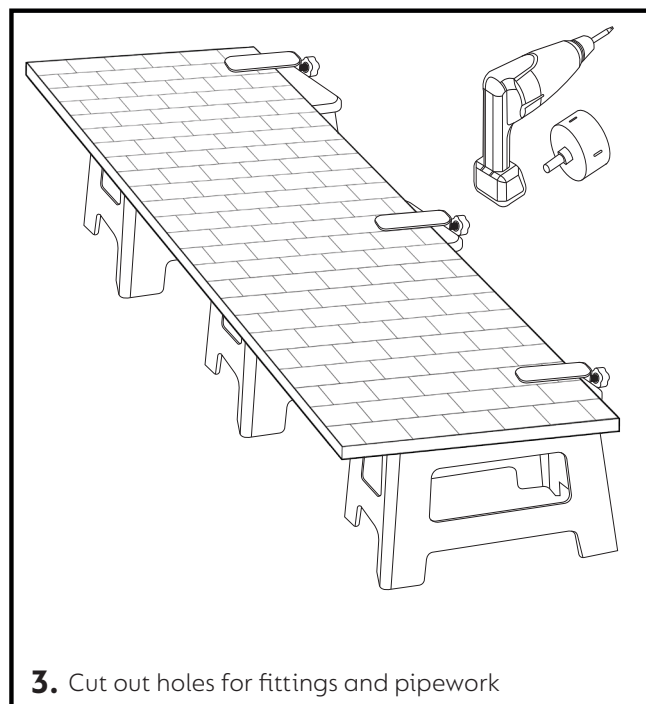
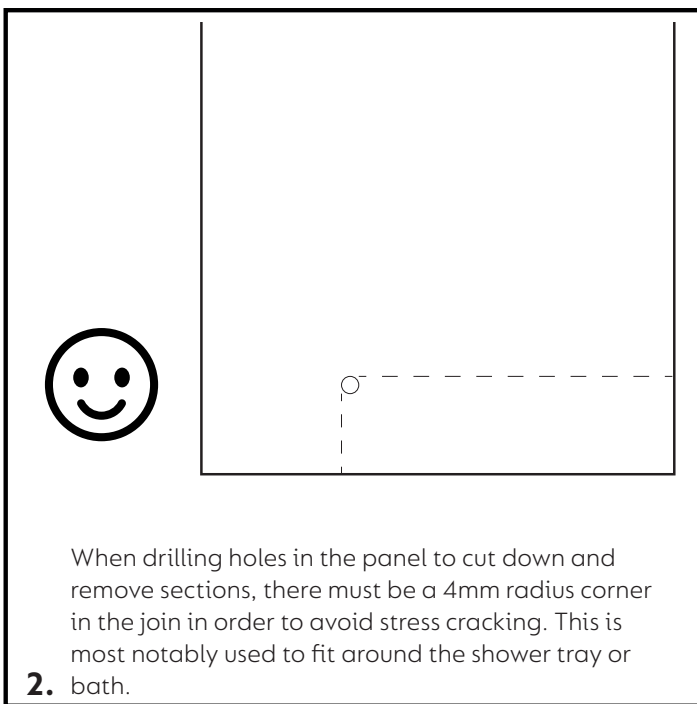
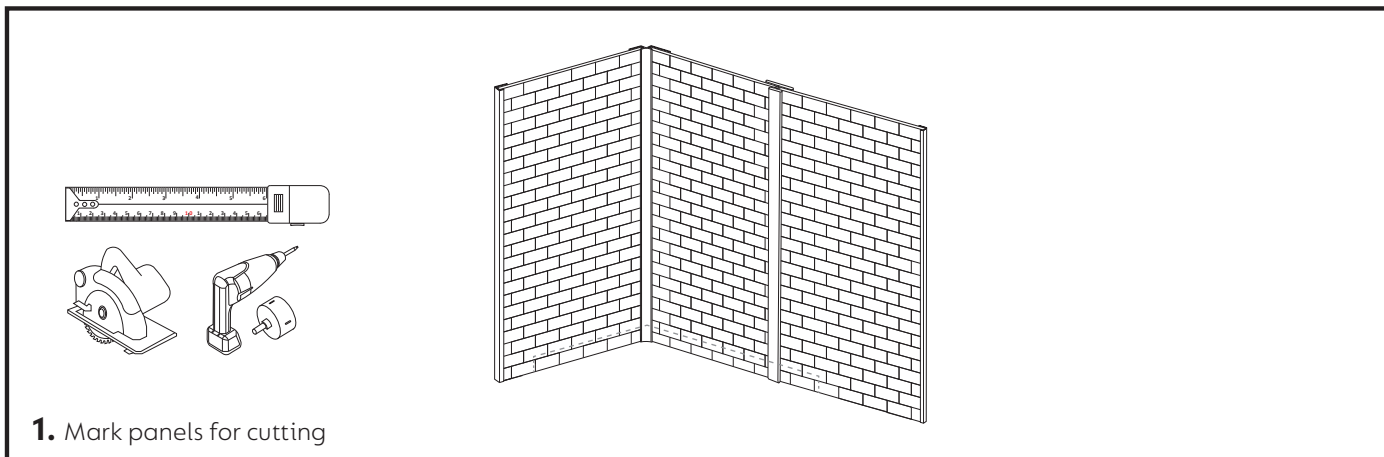

ADHESIVE APPLICATION

We highly recommend performing a **'dry fit'** of the install, for alignment purposes. Then remove the panels, clean the back with a damp clean cloth and allow to dry before undertaking the main install. Adhesive **MUST** be neutral cure.

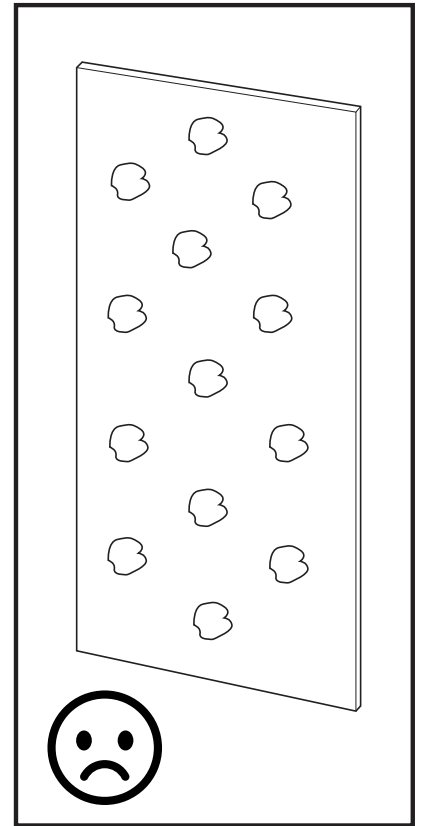
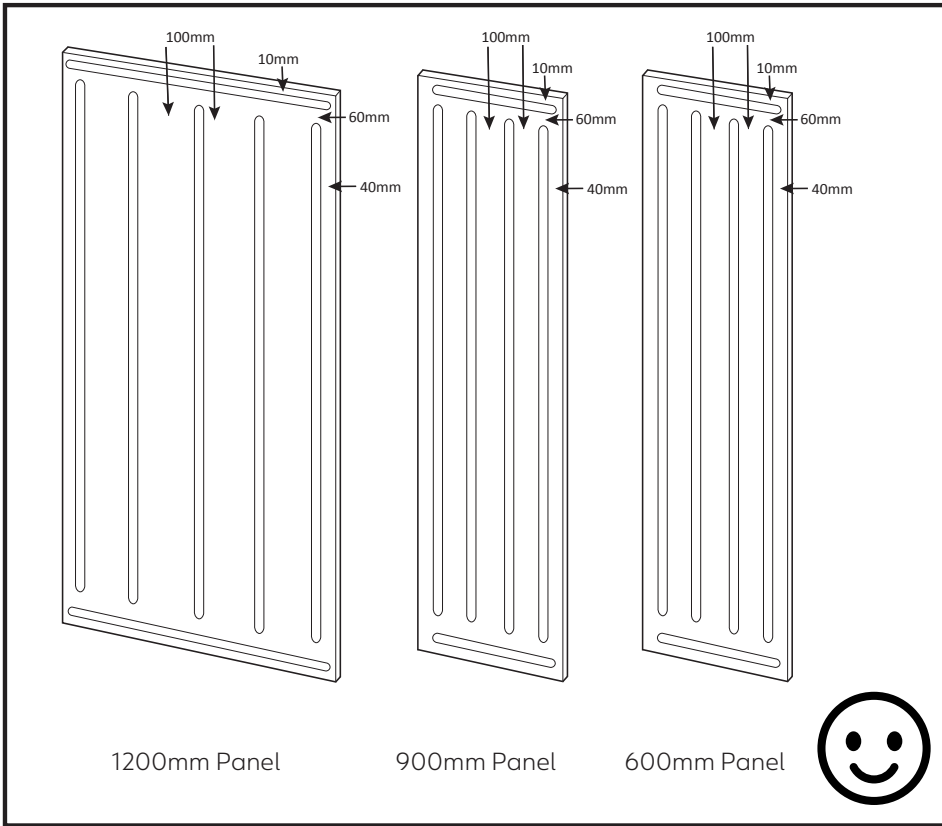

PATTERN ALIGNMENT

Panels will often require trimming to ensure the tiles align, so we recommend you dry fit your panels and make the necessary adjustments before commencing with the install.

Please Note: In some layouts, trimming both the top and bottom edges may produce a neater result.

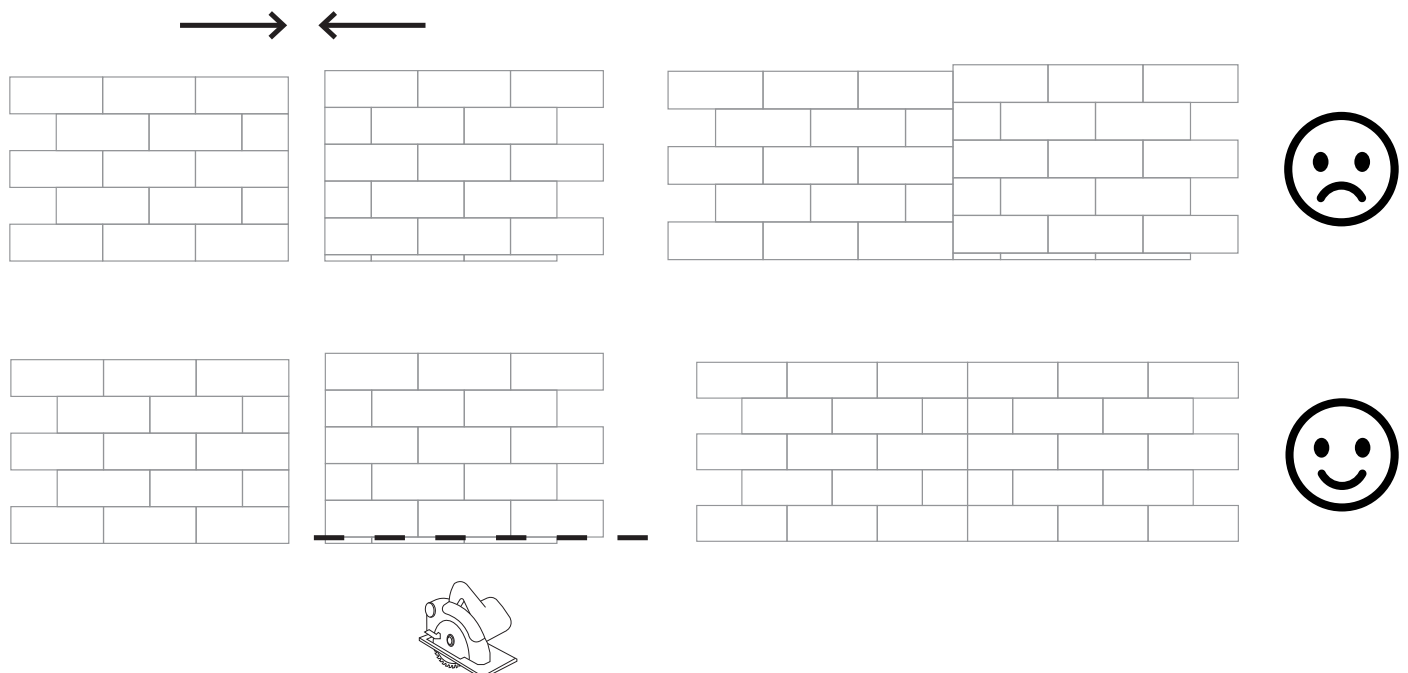

PANEL INSTALLATION

Apply adhesive before fitting each panel

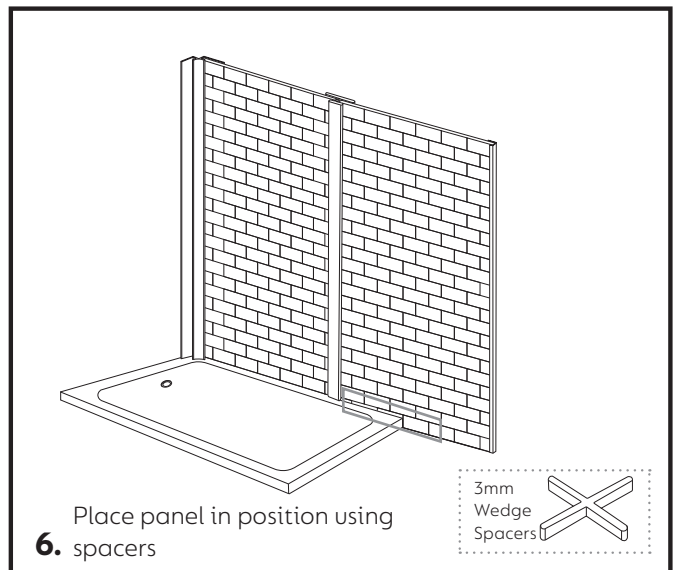
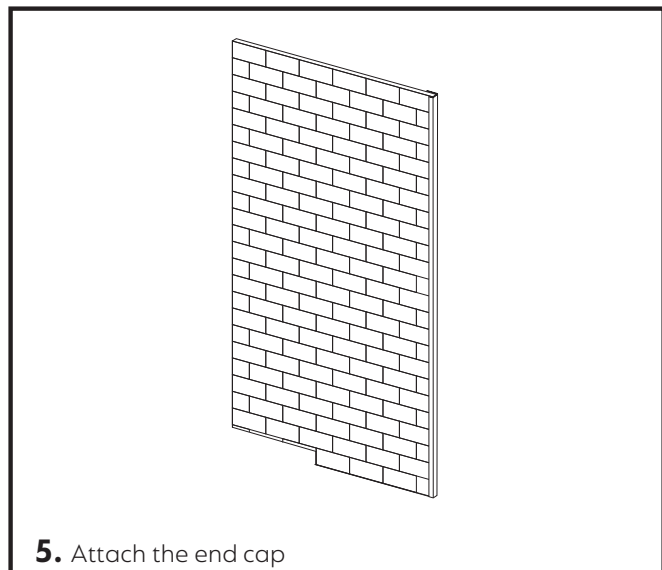
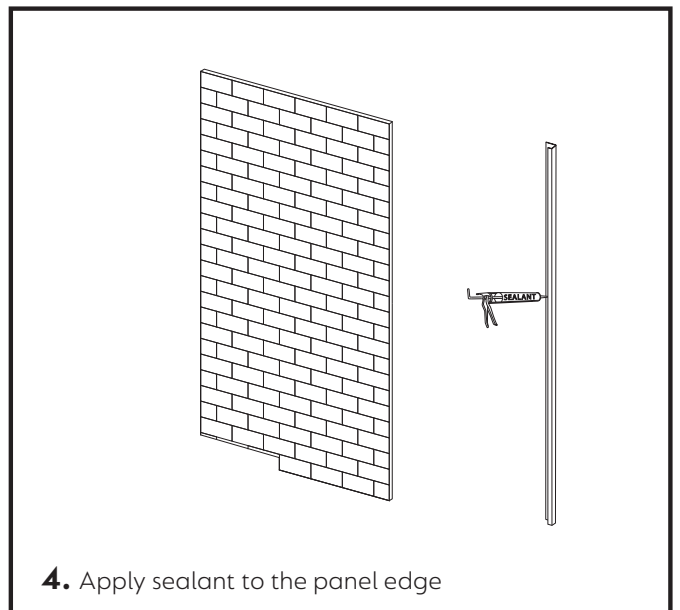
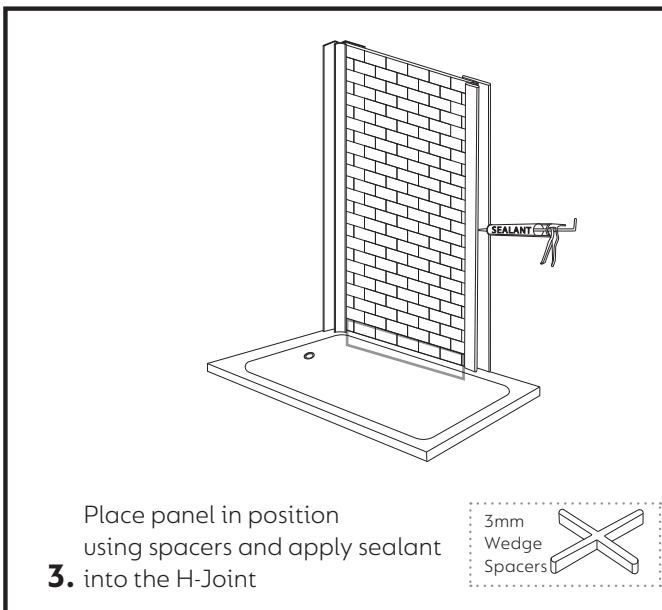
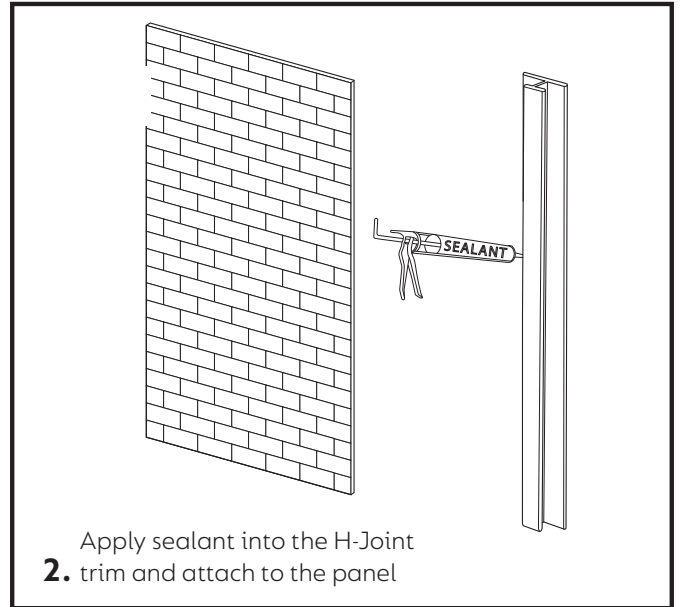
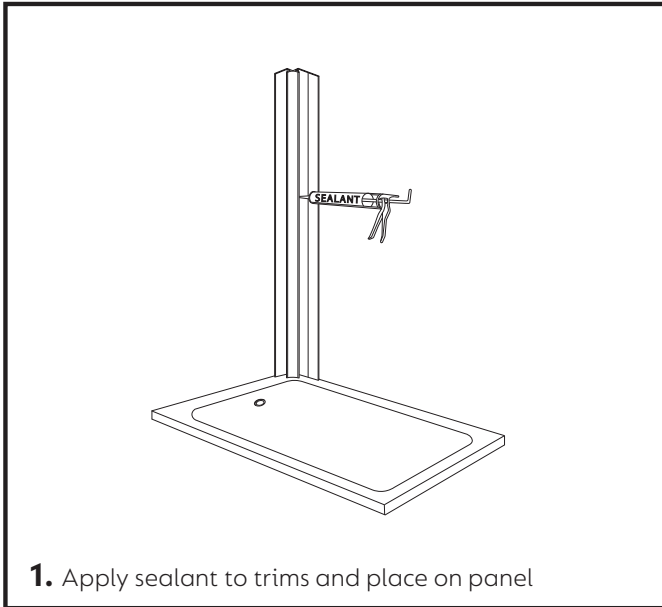

PANEL INSTALLATION

Apply adhesive before fitting each panel

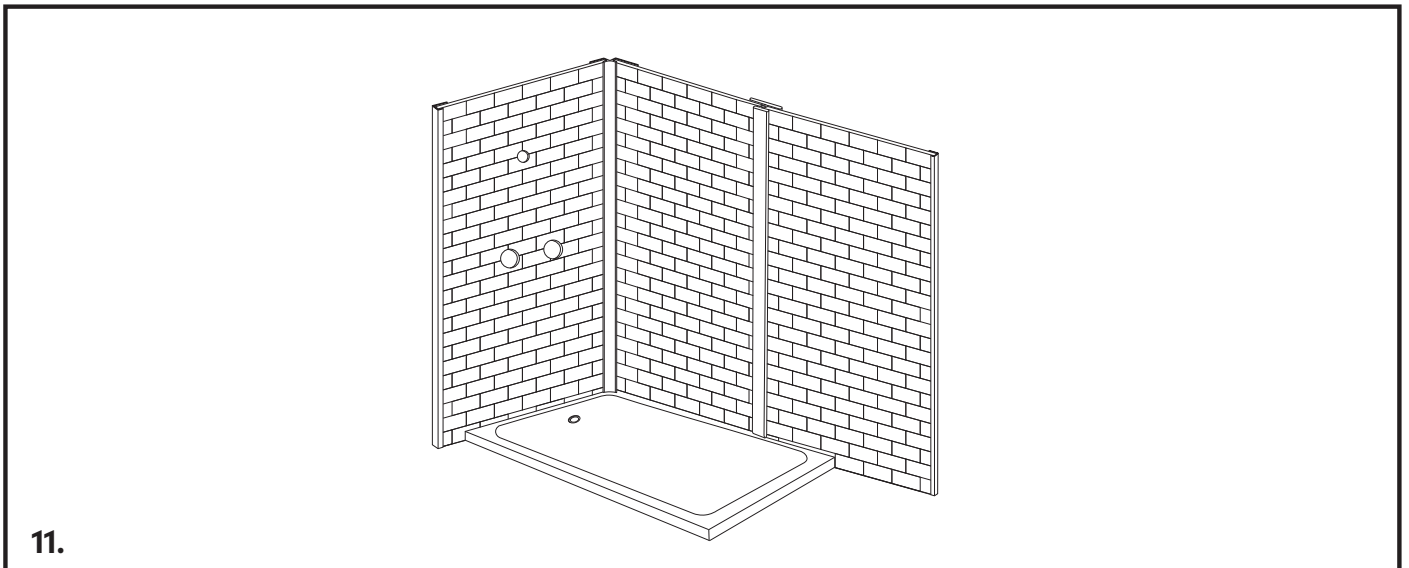
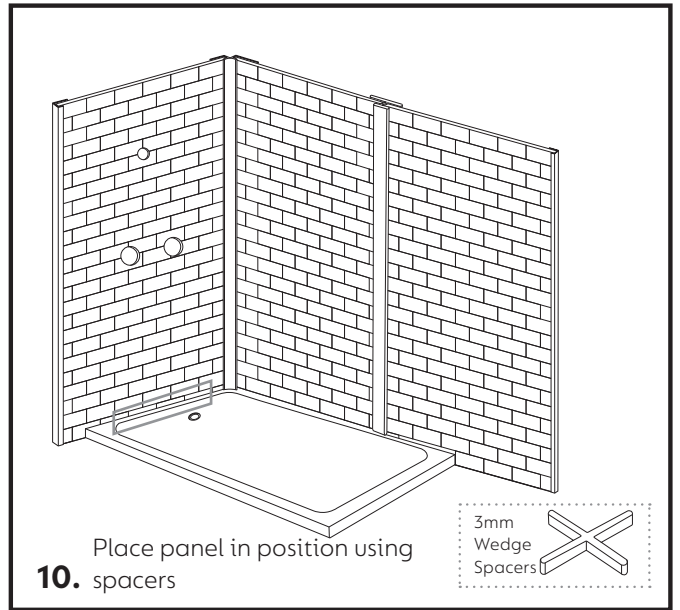
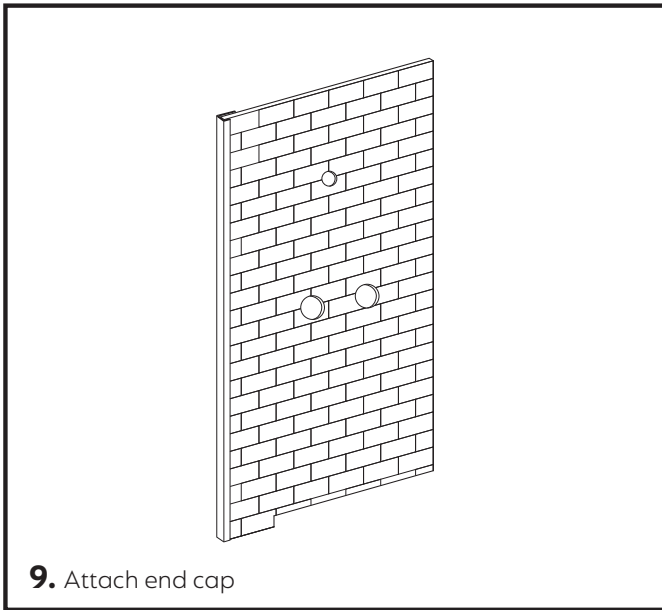
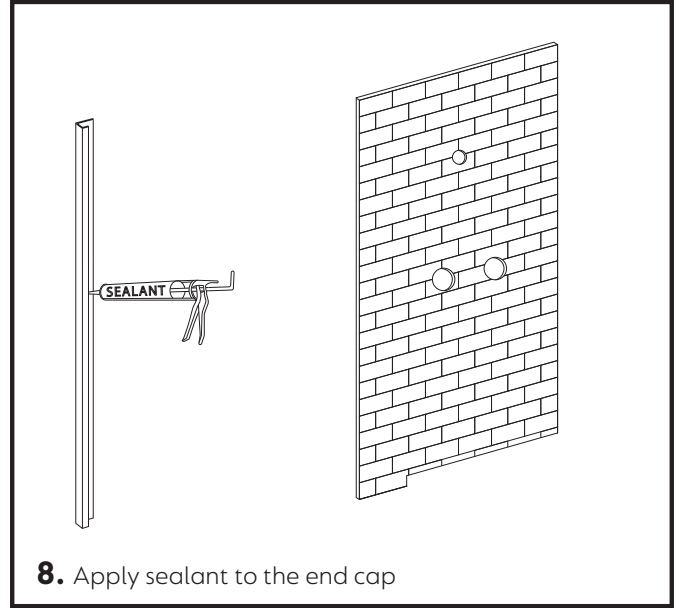
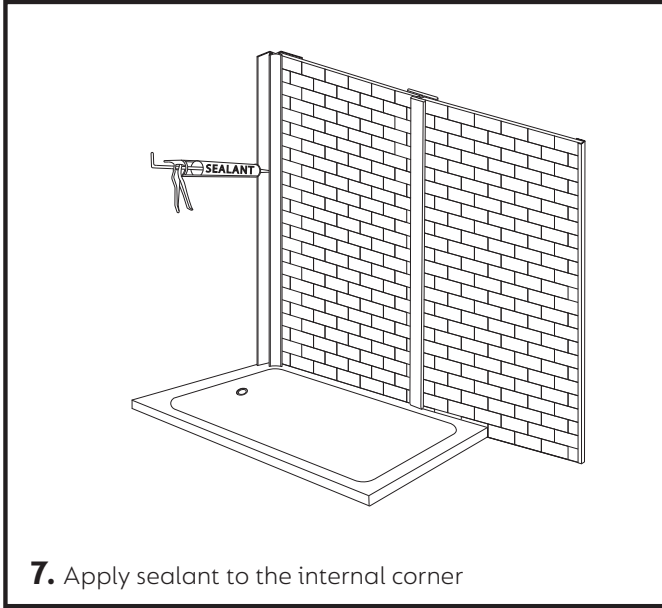

SEALING

